

Use Manual

For LED Ceiling Light



Please read this manual carefully before installation and use of this product

FULGUR, spol. s r.o.
ADD: Svitavska 39, 614 00 Brno Cz
TEL: +420 545 197 213
FAX: +420 545 197211
E-mail: fulgur@fulgur.cz
www.fulgur.cz

Notice for Installation and maintenance

1. Open the lampshade; mark the installed sign on the ceiling according to the holes on the base of the lamp. Drill the holes on the sign with electric drill (hole diameter: $\varnothing 6\text{mm}$, depth of the hole shall be 10mm longer than the length of expansion pipe), and put the expansion pipe (size: 6*30) into the holes with hammer.
2. Put the external power wire through the bushings from the back of the base, and connect the power wire.
3. Connect the lamp base onto the ceiling with tapping screws (size: M4*30mm) and screw it up into the expansion pipe.
4. Make sure the expansion pipe is fastened into the ceiling and tapping screws are installed in the right position. For better heat dissipation effect, no heat insulation cover or similar material is allowed to put on the lamp.
5. Match the rotary joint gap on the lampshade with the rivet on the lamp base, rotate and screw up in the clockwise direction.

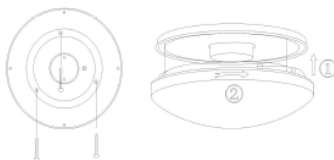

Warranty

Warranty is provided for failure product which is used under normal conditions, and is correctly installed, used and maintained. Within the warranty period, our agent can resort to repairing, replacing (parts or component) or replacing with a new same product for settlement. Any failure caused by inappropriate installation or use which violate the safety criterion, or violate the product instruction is not within the scope of warranty.

CAUTION

For indoor used only. The luminaire cannot be covered by heat-insulating matting or similar material.

Notices:

1. Please replace the protection cover in time for any damage cover.
2. Specifications are subject to change without notice.
3. For safety, it shall be exclusively installed or replaced by the manufacturer or his service agent or a similar qualified person in order to avoid a hazard.